

#5657

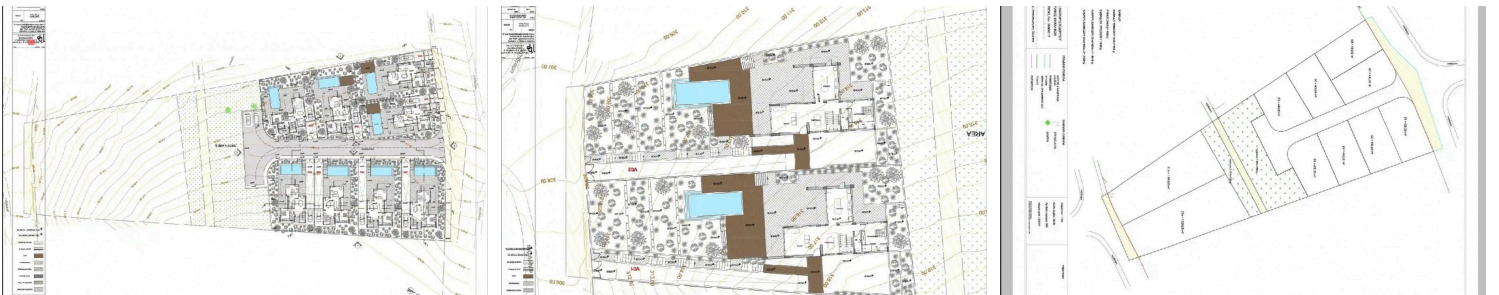
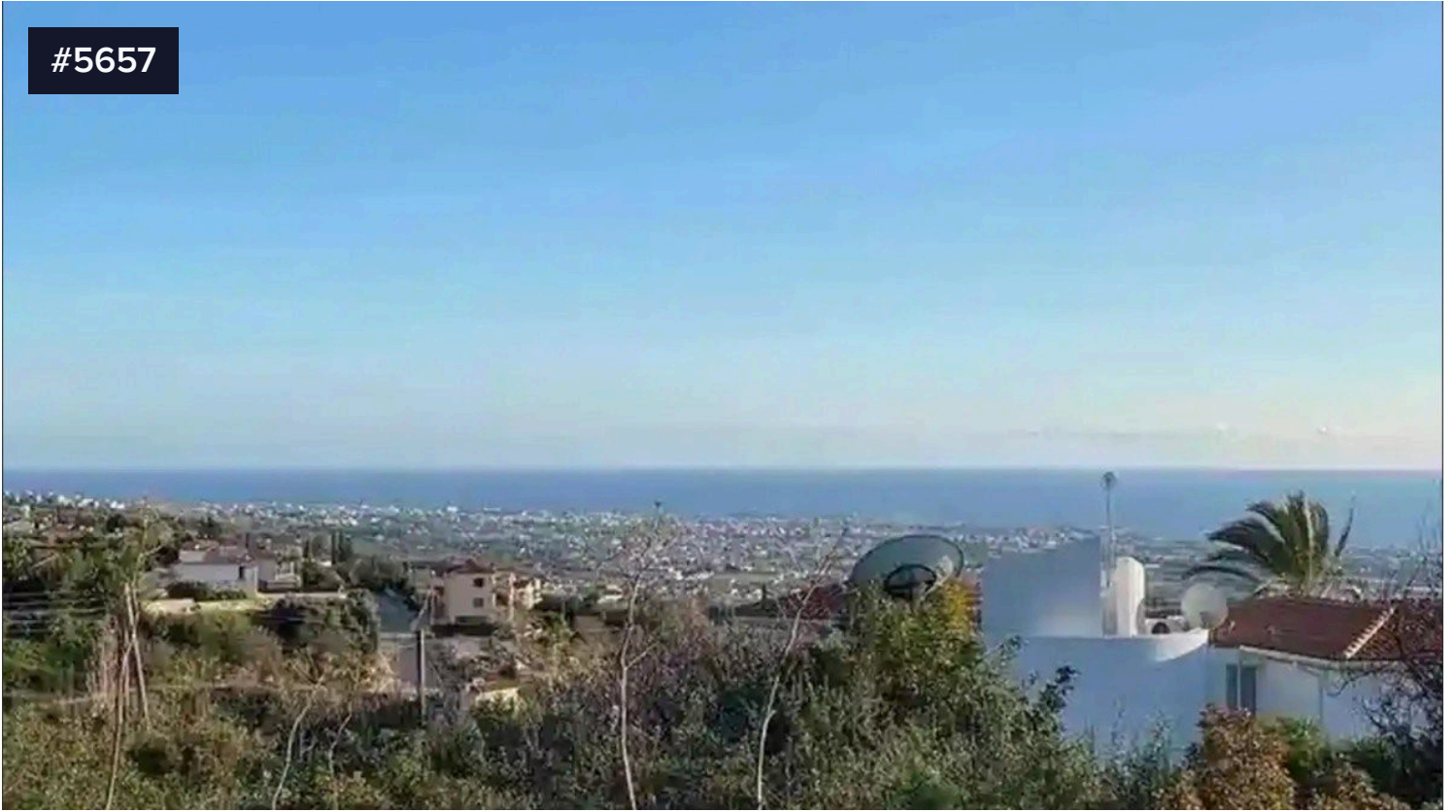

Residential land parcel of 7,358 m² located in the highly desirable area of Kamares, Tala, Paphos €999,000

 Tala - Kamares, Paphos

An exceptional residential land parcel of 7,358 m² located in the highly desirable area of Kamares, Tala, one of the most prestigious hillside communities in Paphos.

The plot benefits from a 30% building density and comes with ready planning permits for the development of 10

Area

 7358 m²

A.T & P.E Homes (Cyprus) Ltd



Sarah Eleni Hibbett

 (+357) 96468749

 sarah@atpehomescyprus.com

