

#3272

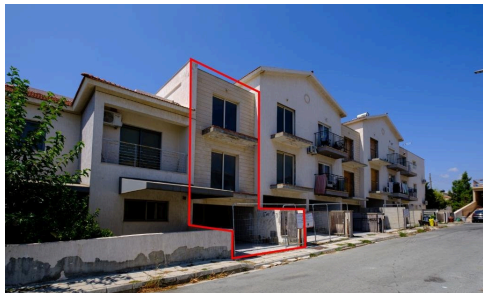

Incomplete house in Episkopi, Limassol

€112,000

📍 Episkopi Lemesou, Limassol

The property is an incomplete house (no. 5) in Episkopi. It is located 110m from Episkopi Elementary School and 2,7km from the coastline. It is part of a residential complex consisting of eleven houses, parking spaces with exclusive right of use, private yards and commonly used areas.

The house is situated on the first floor. It has an internal area of 98sqm, covered verandas of 3sqm and uncovered

Bedrooms

🛏 2

Bathrooms

🚿 1

Covered

🏠 98 m²

A.T & P.E Homes (Cyprus) Ltd



Sarah Eleni Hibbett

☎ (+357) 96468749

✉ sarah@atpehomescyprus.com

